

213 s front st.

pg.1 index

pg.2 irrigation system, automatic crawl space power vents, kitchen sink instant hot water, fan forced radiator heating. Utility room, forced air heating, 65'x1/4" self retracting hose "house plant water" and built in freezer.

pg.3 new comercial electric boiler and wood stove boiler schematics.

pg.4 new comercial electric boiler and wood stove boiler descriptions

pg.5 fan forced radiator schematics

pg 6 Garage hydronic heat system and fold down snow wall.

crawl space power venting
run on auto aproximatly 2 months in spring

PG.2

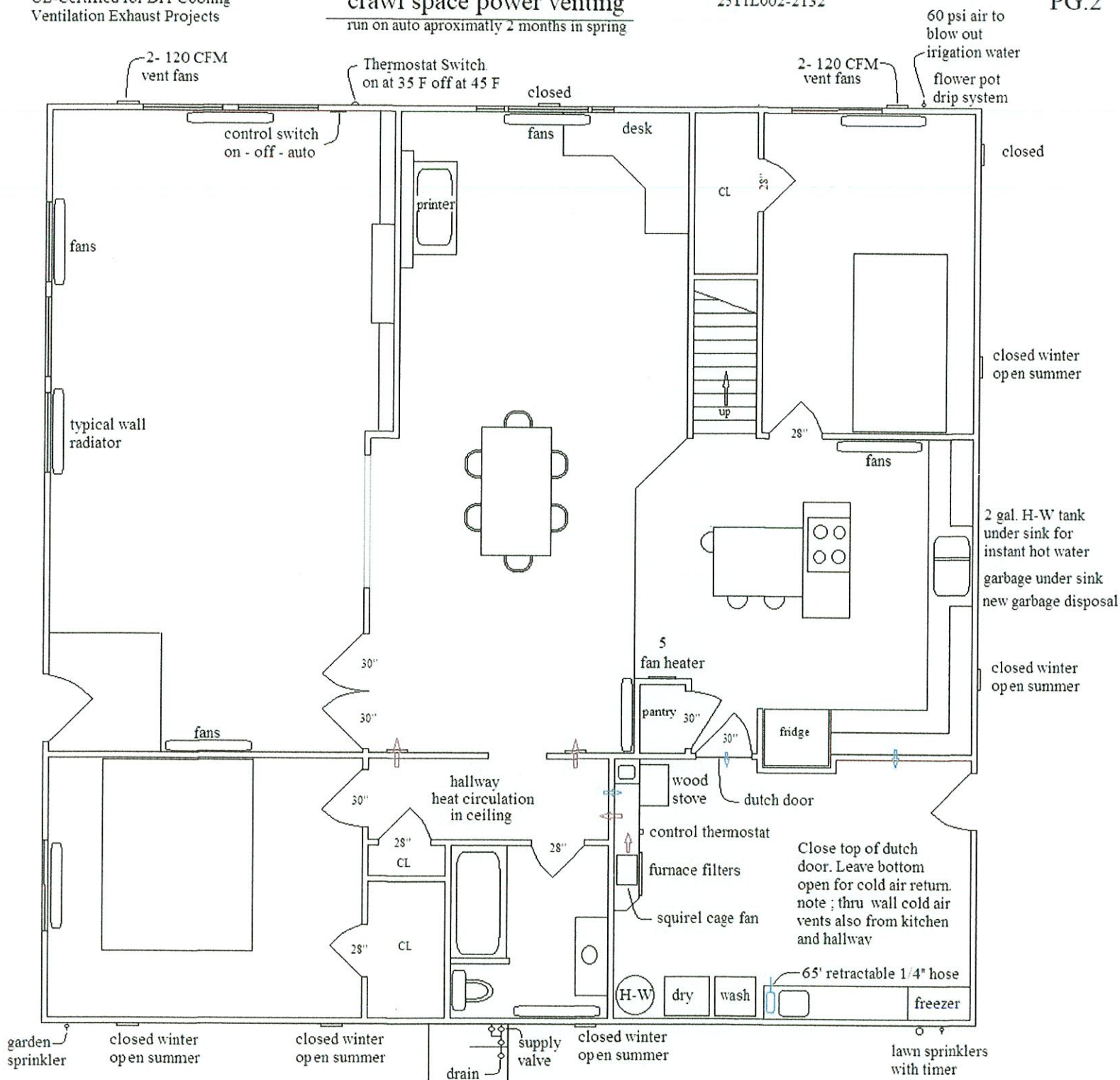

Close supply valve in fall attach air at valve 1 open valve 2, close then open timer valve 3. run till water is empty. open supply valve in spring

HEAT CIRCULATOR

Fan on at 90F off at 83F

Funace Filter, MERV 8. (Actual Size 15 1/2" x 24 1/2" x 3/4")

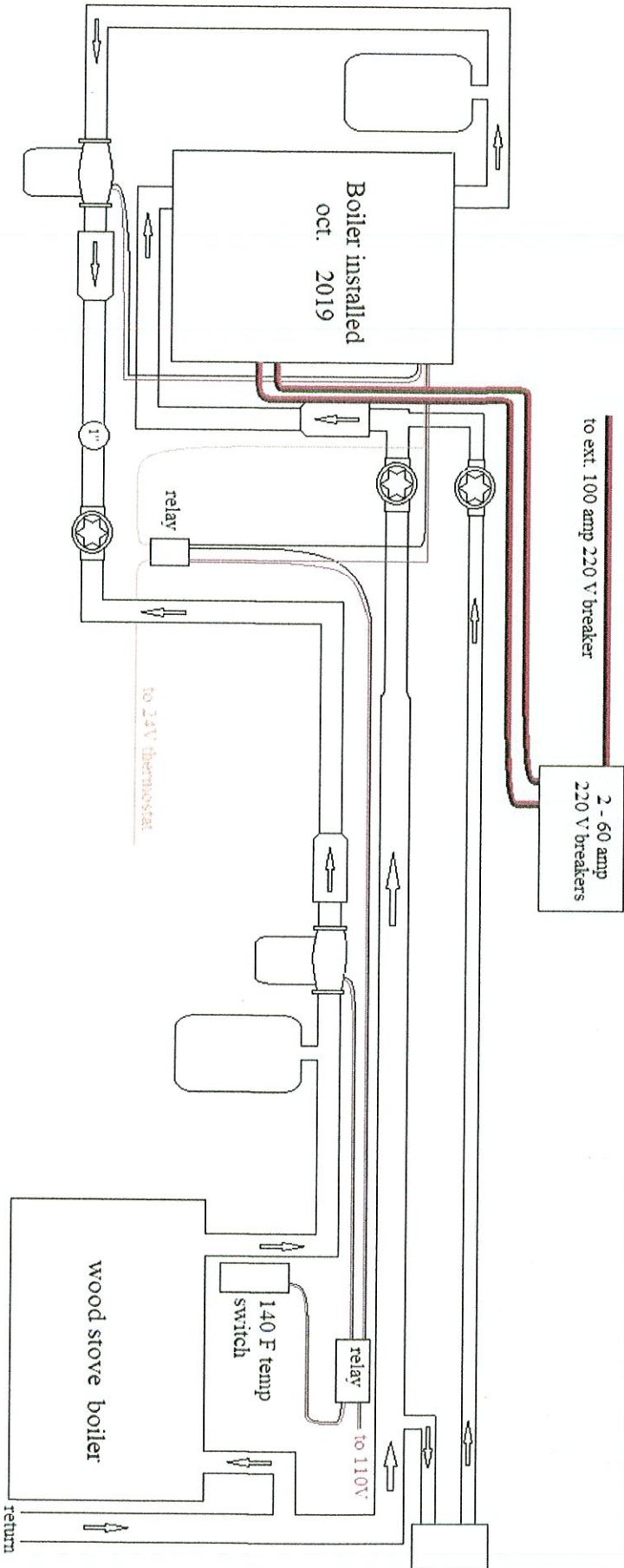
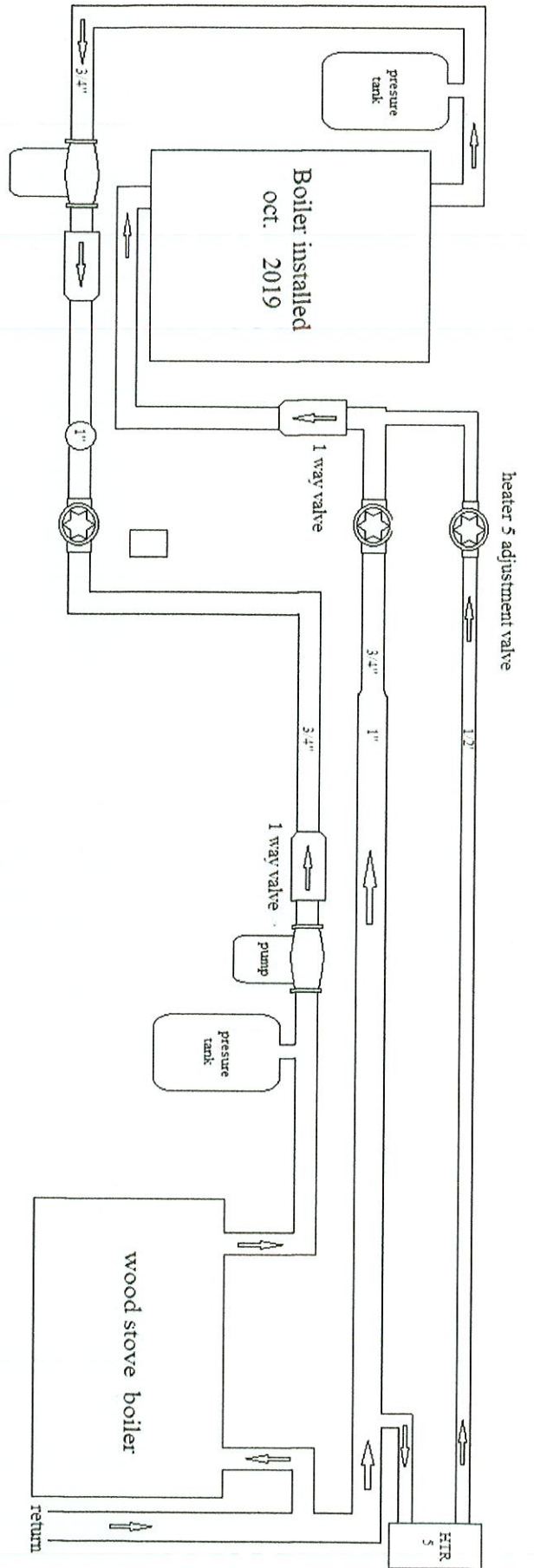

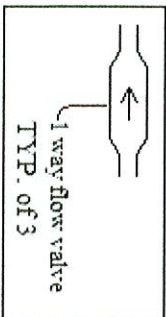

ext. temp

sensor

pressure relief valve

expansion tank

Boiler

Electro Industries
EB-MX-20

.20 kW - 68K BTU -

Hot Water Electric

- 240V - 1 Phase

Temperature range

90 F to 185 F

set at 160 F

installed fall 2019

160 degree

Zone 1.



2" water heat supply to
house radiators

Grundfos circulation pumps

Zone 1. UPS15-58FC, Circulator Pump

three speed Flow Range: 0 - 17 GPM

1/25 hp 115 volt

wood stove boiler.

3. UP15-42F, Circulator Pump

single speed Flow Range: 0 - 17 GPM

1/25 hp 115 volt

2 - 60 amp
220 breakers

relay



wood stove boiler.
has complete
separate system
pressure relief
valve, expansion
tank, pump etc.

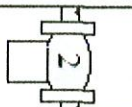

fan wall
heater

insulation

2" water return from
house radiators



Wood stove boiler; Pump 2 on at 140F off at 120F. Power off to pump 1 when pump 2 is on. Relay disconnects home thermostat preventing electric boiler from turning on while wood stove boiler is running.

CRAWL SPACE

Fan forced heaters allows for quicker change and more economical heating

pg.5

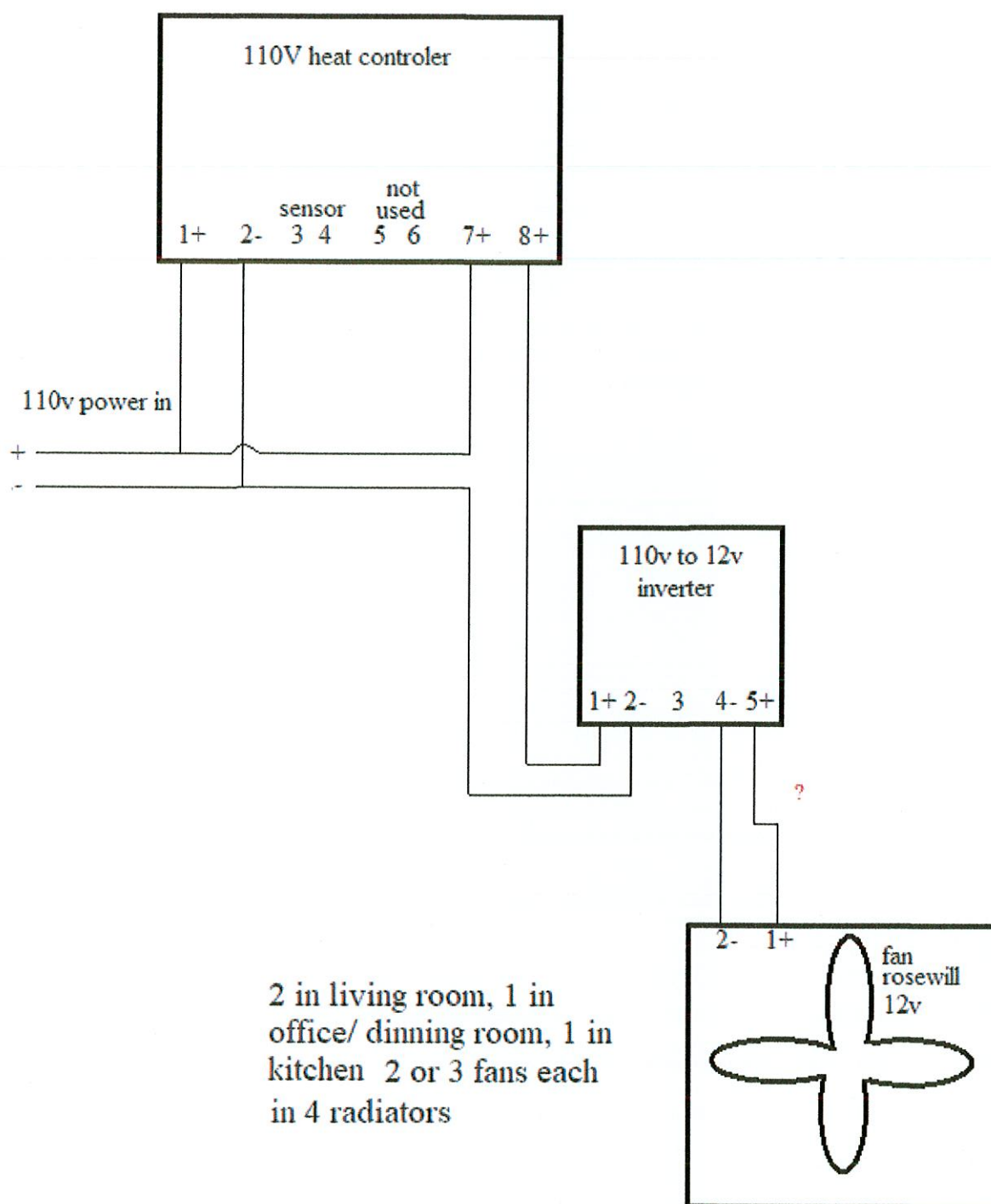

R-30 ceiling
R-13 walls

